

## Daily Cleaning and Maintenance

1. Daily use detergent is allowed for cleaning. The detergent shall not contain pyruvic acid and ammonia elements. Scrub the surface by soft cloth with a little bit oil if the surface of the bathtub is covered with colloid.
2. 1500 grit abrasive paper with tap water is allowed to scrub the crack surface. Put a little toothpaste and polish with soft cloth.
3. Detergent containing a slight acid is allowed for cleaning incrustation surface, such as lemon juice or vinegar. Using soft cloth with that kind warm acid is easy to clean the incrustation surface.
4. Gold plating and chrome parts are not allowed to scrub often, and should be kept away from chemical solvent, acid silicodioxide and silicon sealant gas. Soft cloth is allowed to scrub. Cheesecloth is forbidden.
5. Regular inspection is required on the supply and drainage pipe to avoid jam due to buckling or miscellanies.
6. Jets are allowed to taken down for miscellany cleaning. Clean the jets after the miscellanies like hairs and other variars, are eliminated.
7. Water massage devices cleaning—fill the bathtub with 40°C hot water and add to the water the detergent in 2 g/L. Keep the massage power on lasting for 5 minutes before stop. Drain off the hot water and fill the tub with cold water. Keep massage power on again for 3 minutes, and then stop. Clean the tub.
8. Cleaning for drainer is required once a week.
9. flammable or over 80°C article should be kept away from the product.
10. High pressure, physical crush or intense shake is forbidden when moving the products.
11. Bathtub is required to keep dry, well ventilated and away from corrosive gas.
12. The layout for water, electrical and air piping system is scientifically laid out, installed and firmly fixed. Do not try to adapt its structure.
13. The air piping is from special material and not allowed to be taken place of other plastic material when maintaining.
14. People are not allowed to dismantle the electrical devices except for professional technician.
15. Cleaning to the bath is required immediately after showering. It's easy to get rid of the dirt under such suggestion.

# KARAG

**FORTUNA K-715**  
*Usage & Installation Manual*

bathroom experience...

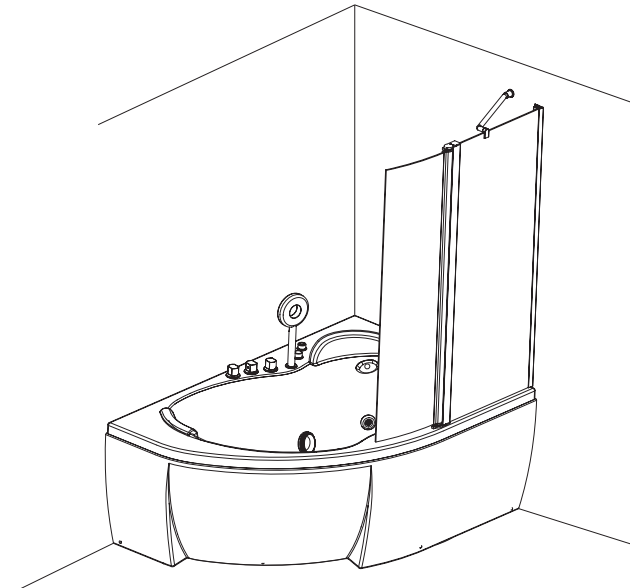

## TABLE OF CONTENT

I	Cover. . . . .	page1
II	Catalogue. . . . .	page2
III	Accessories. . . . .	page3
IV	Installation for bathtub. . . . .	page4
V	Installation for bath screen. . . . .	page5
VI	Using instruction. . . . .	page6
VII	Malfunction and methods. . . . .	page7
VIII	Cleaning and maintenance. . . . .	page8

FOSHAN KORRA BATH WARE CO. LTD.  
 No.5 Xingyedong Road, Zone A, Shishan Science & Technology Industrial Park,  
 Nanhai, Foshan, China  
 Tel: 0086-757-86696968 86696963 86696962  
 Fax: 0086-757-86696965  
 Http://www.korraware.com  
 E-mail: master@korraware.com

## Malfunction and methods

False	Factors	Methods of maintenance
No power or current Circuit breaker trips	1. power poor contact, or power off.	1. inspection power connect condition, keep power on
	2. power or circuit cutting-out or leakage	2.inspection the power, circuit and earthing, preclude the leakage and earthing
Water pump doesn't work	1. power off	1. keep power on
	2. pump fan broken	2.inspection the fan, clear away the truck
	3. pump blankrun	3.repalce the broken pump
Water massage power Cannot be adjusted	1. attraction force weak	1.check the pump well assembled
	2.air switch working abnormally	2.replace a new air switch
	3. jets jam	3.clear away the truck
Pipe leaks	1. seal gasket in bad condition	1.replace the seal gasket
	2. screw loose	2.firm the screw
	3. joint point connecting bad	3.put new glue to connect
	4. pipe broken	4.repalce the broken pipe
Control panel doesn't work	1. wire not in connect, circuit trip	1.inspection on the wire, reconnect
	2. switch of the panel doesn't work	2.replace the broken control panel
No lighting	1. light broken	1.replace the broken light
	2. wire cut	2.reconnect the circuit
	3.control panel broken	3.maintain or replace the control panel
No sounds	1.speaker broken	1.repalce the speaker
	2.wire cut	2. connect the wire
	3. control panel broken	3. maintain or replace the control panel

# Installation for bath screen

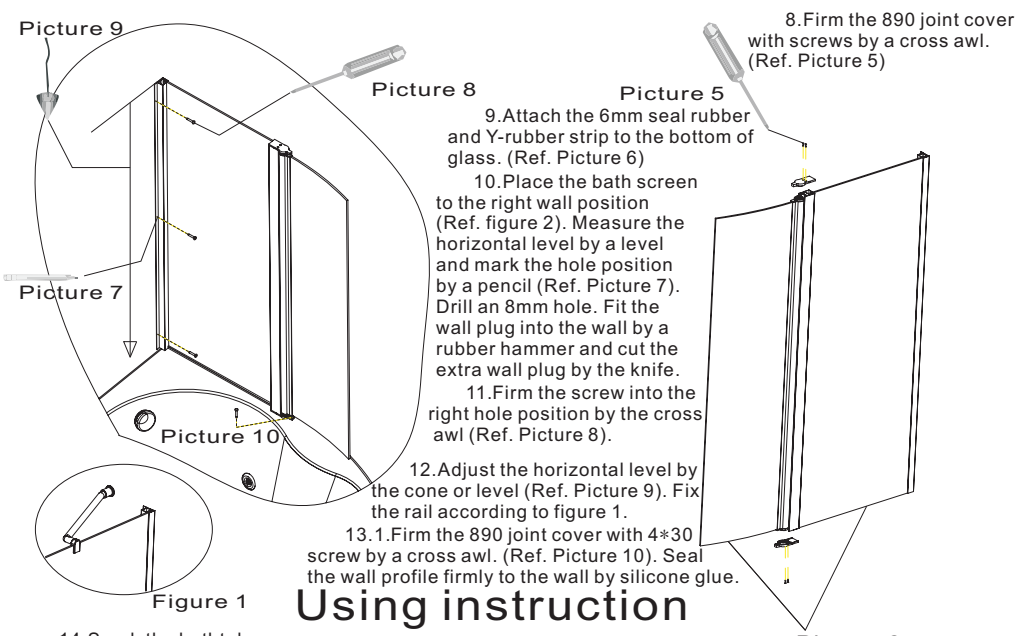

## Using instruction

14. Scrub the bathtub and bath screen by a soft cloth after installation.
15. Air switch (Button 10), push the switch to start the massage power and push again to stop the power.
16. Regulating switch (Button 11), circle the button clockwise to obtain weak massage power, while counterclockwise to obtain strong power.
17. Faucet (Button 12), circle the button clockwise to obtain shower hand function, while counterclockwise to obtain jets function.
18. Faucet (Button 13), clockwise for hot water while counterclockwise for closing hot water.
19. Faucet (Button 14), clockwise for cold water while counterclockwise for closing cold water.

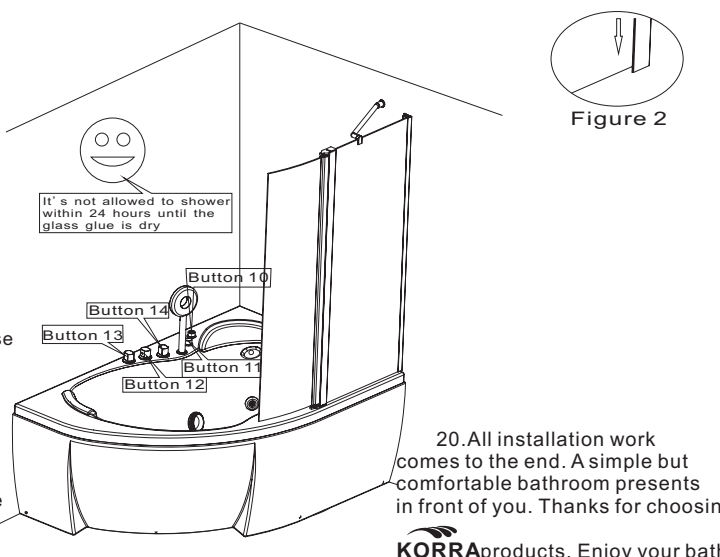

# ACCESSORIES

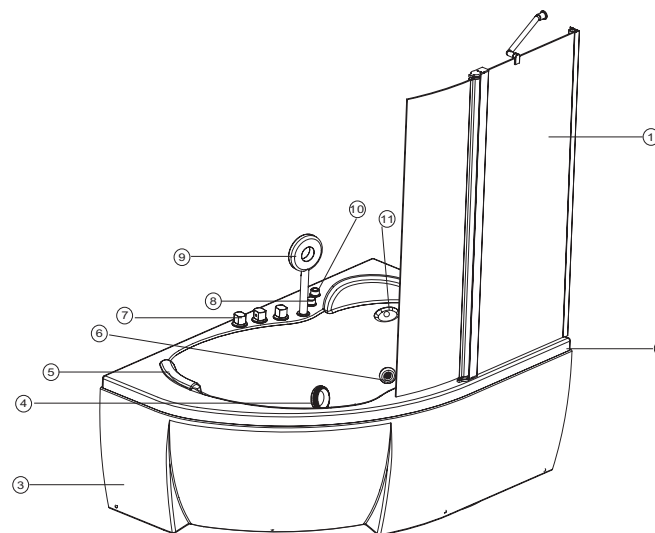

NO	Accessories	NO	Accessories	NO	Accessories
①	K-890 screen	⑥	∅ 90 jet	⑪	1086 massage waterfall
②	K-1091A bathtub body	⑦	Faucet(S-562)	⑫	
③	K-1091A bathtub pane	⑧	Regulating switch	⑬	
④	90° elbow	⑨	Hand shower 2900	⑭	
⑤	TX-5 pillow	⑩	Air switch	⑮	

## Accessory Package

Accessories	Unit	Quantity	Accessories	Unit	Quantity
Hand shower 2900	pc	1	4*16 screw	pcs	4
890 joint cover	set	2	6mm seal	M	0.52
Tx-5 pillow	pc	1	Y-rubber strip(6*16)	M	0.356
1091A connecting rail	pc	1	1091A instruction paper	pc	1
Wall plug	pcs	3			
4*30 screw	pcs	4			
Screw cover(chrome)	pcs	3			

# Installation for bathtub

## 1. Installation materials and tools :

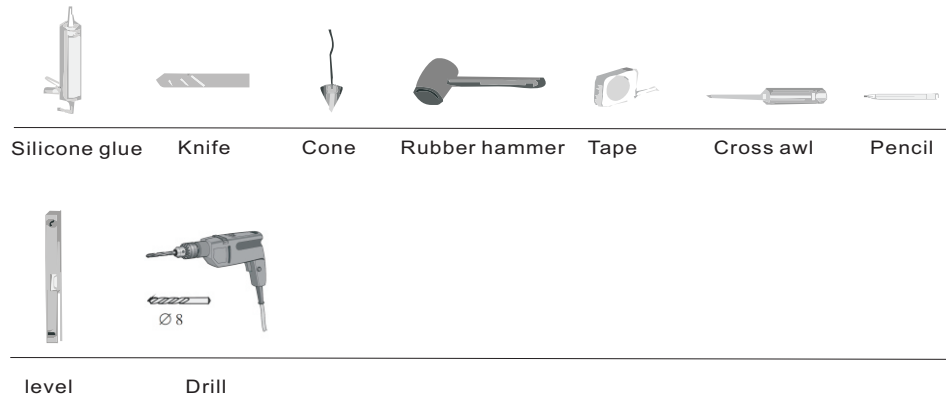

## 2. Installation of water and electrical system :

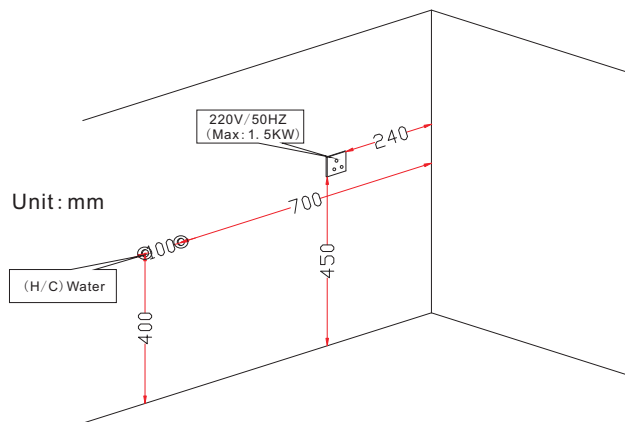

1. Prepare necessary tools and check the package whether in good condition before installation.
2. Measure the position of input water and clean the pipe. Connect the hot and cold water pipe.
3. Clean the waste water pipe and floor to place the bathtub.

4. Firm the stand of the bathtub (Ref. Picture 2). Adjust the horizontal level (Ref. picture 3).  
Connect the hose pipe to the waste hole (Ref. Picture 1).
5. Connect the hand shower and place into the shower bracket.
6. Test the drainage system after bathtub installed.

## 3. Installation for bathtub :

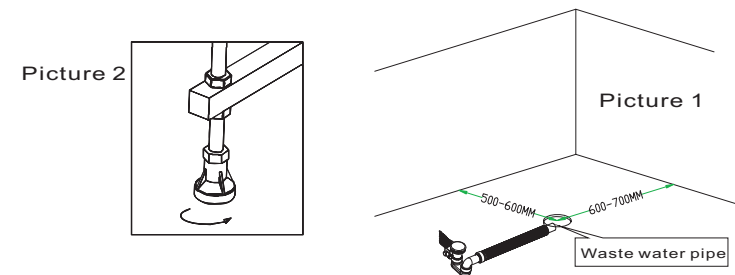
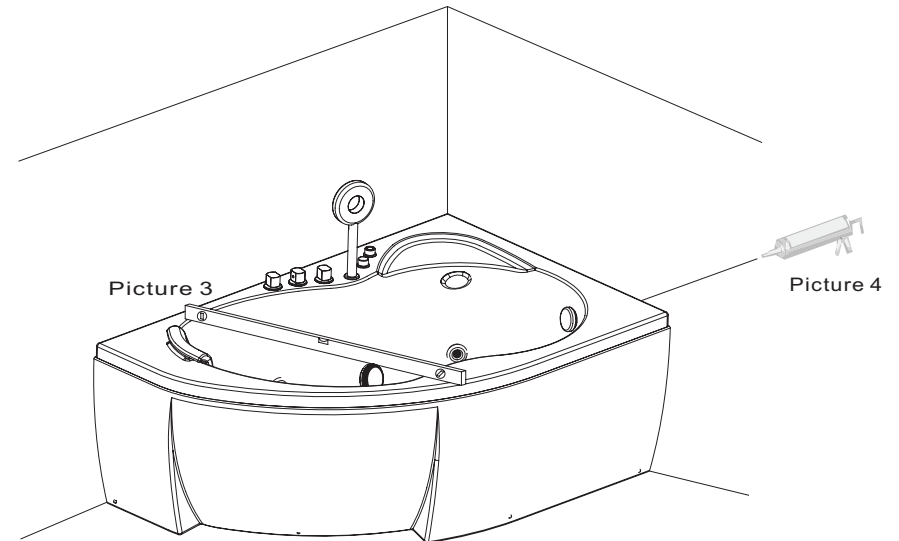

7. Seal the surrounding with silicone glue. (Ref. Picture 4).